

Royal Holloway University of London, TW20 0EX

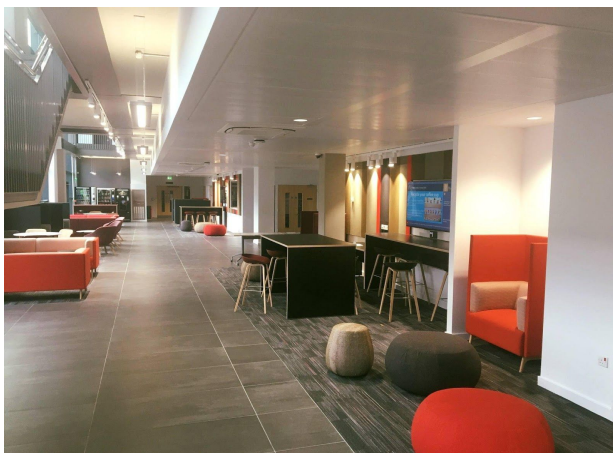

| | | |
|-----------|---|--|
| Sector | Education | Construction of a new Electronics and Engineering Building for the Royal Holloway University of London. Our package consisted of SFS, linings, partitions, grid and solid ceilings as well as acoustic rafts and suspended acoustic wall panels. |
| MC | Osborne | |
| Architect | Stride Treglown | |
| Client | Royal Holloway University of London | |
| Value | £600k | |
| Date | 2017/18 | |
| Package | SFS, Partitions, Ceilings and Acoustic Panels | |

Royal Holloway University
of London, TW20 0EX

